

# Google Stock Price Prediction Using Just Neural Network

Mohammed Mkhaimar AbuSada, Ahmed Mohammed Ulian, Samy S. Abu-Naser

Department of Information Technology, Faculty  
of Engineering and Information Technology,  
Al-Azhar University, Gaza, Palestine

**Abstract:** The aim behind analyzing Google Stock Prices dataset is to get a fair idea about the relationships between the multiple attributes a day might have, such as: the opening price for each day, the volume of trading for each day. With over a hundred thousand days of trading data, there are some patterns that can help in predicting the future prices. We proposed an Artificial Neural Network (ANN) model for predicting the closing prices for future days. The prediction is based on these features (date, opening price, highest price, lowest price, volume), which were used as input variables and (closing price) as output variable for our ANN model. Our model was created, trained, and validated using data set in JNN environment, which its title is "Google-Stock-Prices". The model evaluation showed that the ANN model is able to predict correctly 99.48% of the validation samples.

**Keywords:** Predictive Analysis, Artificial Neural Networks, Stock Price prediction.

## Introduction

In this study, we will analyze the dataset which contains various information of Google company stock prices over the years. This dataset also includes information on the date of stock changes, open price and close prices, as well as the lowest and highest prices and the trading volume for each day. Artificial neural networks (ANNs) will be used for the analysis. Artificial neural networks are like biological neural networks and offer a technique, which solves the problem of prediction [3]. Neural networks contain input, hidden and output layers. Hidden layers convert the input into usable thing to the output layer [5]. The ANN Model goes through training and validation on a dataset. Training in which that the network is trained is done on a dataset. Then a configuration is done to the weights of the connections between neurons. Validation in which that the network is validated to determine the prediction of a new dataset [6]. In this study, we used about 38% of the dataset instances for network validation, the remaining 62% for training. ANN Architecture is shown in figure 1.

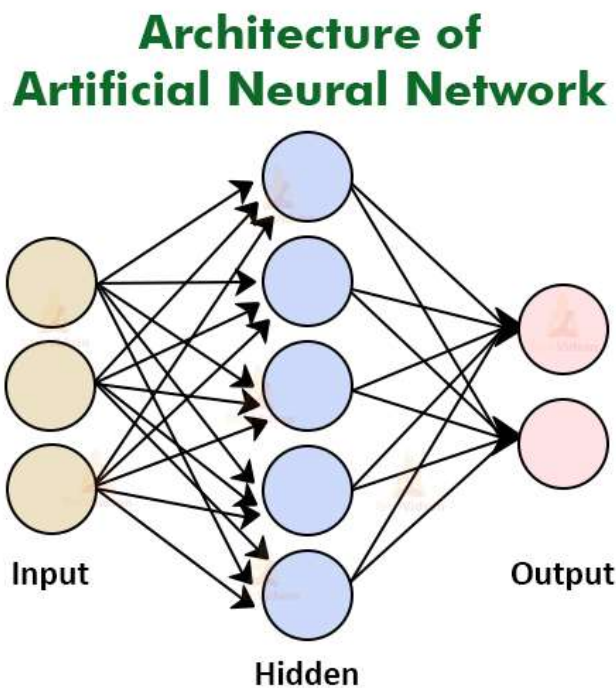

Figure 1: ANN Architecture

## 1. Literature Review

Artificial Neural Networks have been used many fields. In Education such as: Predicting Student Performance in the Faculty of Engineering and Information Technology using ANN[5], Prediction of the Academic Warning of Students in the Faculty of Engineering and Information Technology in Al-Azhar University-Gaza using ANN[5], Arabic Text Summarization Using AraBERT Model Using Extractive Text Summarization Approach[6].

In the field of Health such as: Parkinson's Disease Prediction [7], Classification Prediction of SBRCTs Cancers Using ANN [7], Predicting Medical Expenses Using ANN[8], Predicting Antibiotic Susceptibility Using Artificial Neural Network[8], Predicting Liver Patients using Artificial Neural Network[7], Blood Donation Prediction using Artificial Neural Network[9], Predicting DNA Lung Cancer using Artificial Neural Network[10], Diagnosis of Hepatitis Virus Using Artificial Neural Network[10], COVID-19 Detection using Artificial Intelligence[11].

In the field of Agriculture: Plant Seedlings Classification Using Deep Learning [12], Prediction of Whether Mushroom is Edible or Poisonous Using Back-propagation Neural Network[15], Analyzing Types of Cherry Using Deep Learning[21], Banana Classification Using Deep Learning[13], Mango Classification Using Deep Learning[14], Type of Grapefruit Classification Using Deep Learning[7], Grape Type Classification Using Deep Learning[3], Classifying Nuts Types Using Convolutional Neural Network[2], Potato Classification Using Deep Learning[3], Age and Gender Prediction and Validation Through Single User Images Using CNN[5].

In other fields such as : Predicting Software Analysis Process Risks Using Linear Stepwise Discriminant Analysis: Statistical Methods [14], Predicting Overall Car Performance Using Artificial Neural Network [8], Glass Classification Using Artificial Neural Network [9], Tic-Tac-Toe Learning Using Artificial Neural Networks[14], Energy Efficiency Predicting using Artificial Neural Network[15], Predicting Titanic Survivors using Artificial Neural Network[14], Classification of Software Risks with Discriminant Analysis Techniques in Software planning Development Process[13], Handwritten Signature Verification using Deep Learning[12], Email Classification Using Artificial Neural Network[14], Predicting Temperature and Humidity in the Surrounding Environment Using Artificial Neural Network[12], English Alphabet Prediction Using Artificial Neural Networks[9].

## 2. Methodology

We downloaded a data set from *kaggle* that contains stock price information from *google*. This dataset created by the user. We did some preprocessing on the data, and then we trained our ANN model and validated it.

## 3. Original Dataset Description

Table 1: Original Dataset Description

#	Attribute	Description	Type
1.	Date	The date this data was captured	Date
2.	Open Price (Open)	The opening price of the stock or asset on a given trading day. It is the price at which the first trade of the day occurred	Real
3.	High Price (High)	The highest price at which the stock or asset traded during the trading day. It represents the maximum price reached during the day.	Real
4.	Low Price (Low)	The lowest price at which the stock or asset traded during the trading day. It represents the minimum price reached during the day.	Real
5.	Closing Price (Close)	The closing price of the stock or asset on the same trading day. It is the price at which the last trade of the day occurred.	Real
6.	Volume	The total number of shares or units of the stock or asset traded during the trading day. Volume indicates the level of trading activity for the asset on that particular day. High volume can suggest strong interest or activity in the stock.	Integer

### 3.1 Dataset Preprocessing

We wanted to use this dataset to build an ANN model to predict the stock price (closing price) for google (attribute number 5).

The first thing we had to do, is choose a suitable factor for this prediction, and delete the unnecessary ones, we chose these factorsto be our input to the predictive model: open, high, low, volume, date.

Moreover, the dataset contains 4000 instances. which is a large a number to a neural network to deal with, so, we divided these samples to 2500 training instances, and 1500 validation instances.

In addition, because of the integer numbers of the inputs are too large comparing with the real rate values, we did a normalizationto them so all the data are real.

Normalization formula was:

$$\text{Normalized value (xi)} = \frac{xi - X_{min}}{(X_{max} - X_{min})}$$

While checking the instances, it has been noticed that there were validation instances that are out of range, we converted them to training. Now, the dataset is ready for training and validation.

### 3.2 Our ANN Model

The resulted predictive ANN model is shown in Figure 2 and Figure 6.

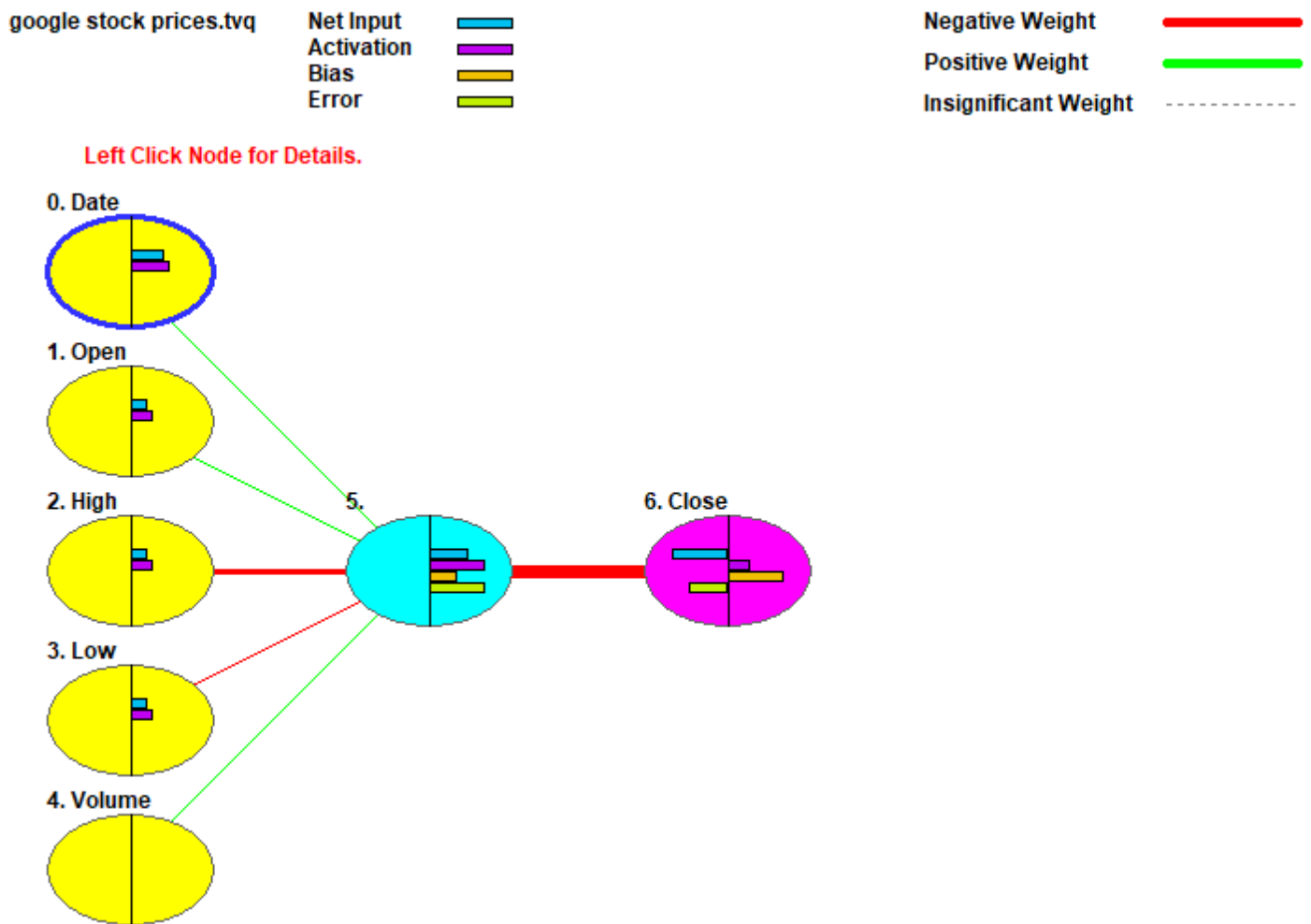

Figure 2: Our ANN Model

### 3.3 Validation

Our ANN model was able to predict google stock prices overall rate with 99.48% accuracy, with about 0.005 errors as seen in figure (3). Furthermore, The Model showed that the most effective factor in a stock rate is the closing price. More details are shown in figure (4).

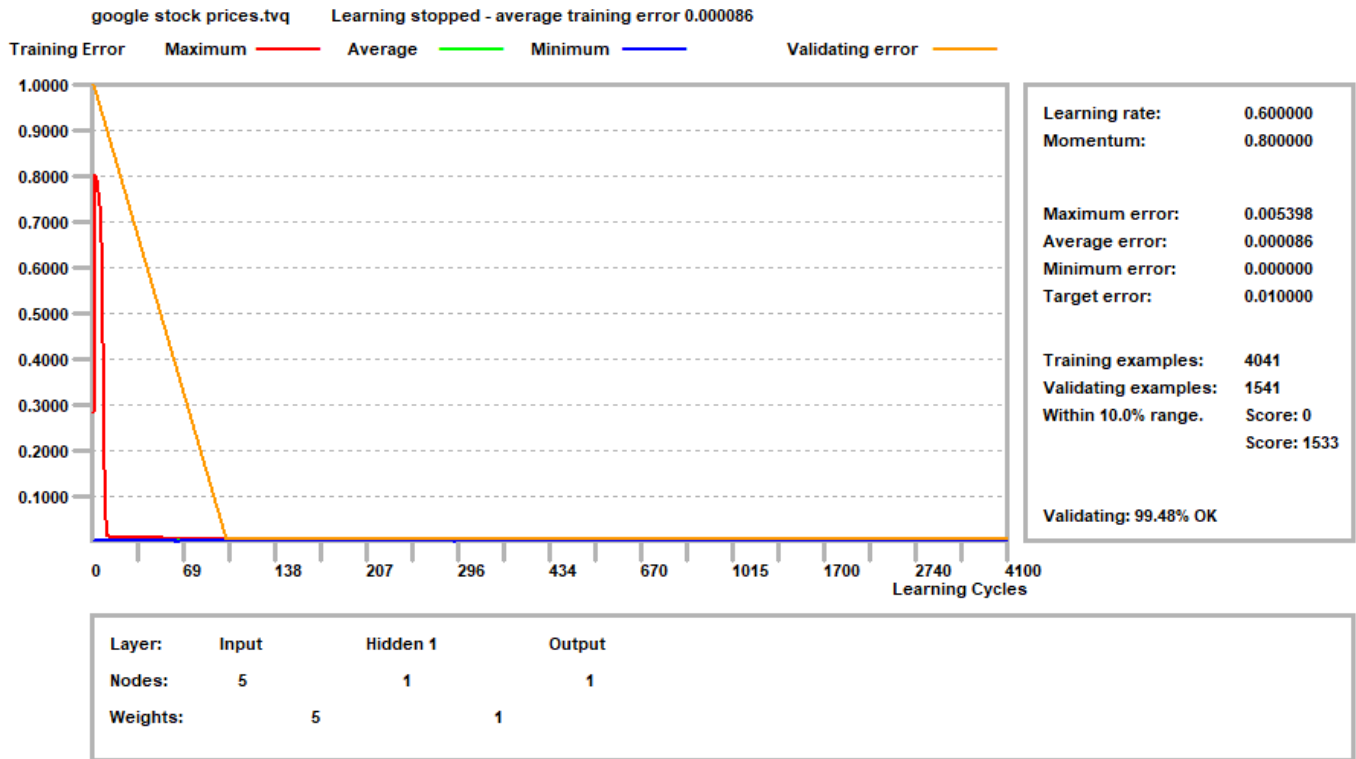

Figure 3: Validation and Errors

google stock prices.tvq 3907 cycles. Target error 0.0100 Average training error 0.000086  
 The first 5 of 5 Inputs in descending order.

Column	Input Name	Importance	Relative Importance
2	High	3.2463	<div style="width: 100%; height: 10px; background-color: green;"></div>
3	Low	1.7779	<div style="width: 55%; height: 10px; background-color: green;"></div>
1	Open	0.7512	<div style="width: 23%; height: 10px; background-color: green;"></div>
4	Volume	0.0340	<div style="width: 1%; height: 10px; background-color: green;"></div>
0	Date	0.0231	<div style="width: 0%; height: 10px; background-color: green;"></div>

Figure 4: Attributes Importance

	Date	Open	High	Low	Volume	Close
#0	8/19/2004	0.1002	0.1006	0.1000	0.5326	0.1001
#1	8/20/2004	0.1004	0.1018	0.1011	0.3187	0.1020
#2	8/23/2004	0.1028	0.1028	0.1033	0.2738	0.1023
#3	8/24/2004	0.1029	0.1024	0.1019	0.2443	0.1012
#4	8/25/2004	0.1014	0.1015	0.1020	0.1849	0.1014
#5	8/26/2004	0.1014	0.1015	0.1022	0.1644	0.1019
#6	8/27/2004	0.1022	0.1016	0.1024	0.1558	0.1015
#7	8/30/2004	0.1015	0.1009	0.1015	0.1458	0.1005
#8	8/31/2004	0.1008	0.1005	0.1015	0.1431	0.1006
#9	9/1/2004	0.1009	0.1003	0.1009	0.1845	0.1001
#10	9/2/2004	0.1000	0.1002	0.1007	0.2431	0.1004
#11	9/3/2004	0.1004	0.1000	0.1008	0.1454	0.1000
#12	9/7/2004	0.1004	0.1001	0.1009	0.1522	0.1004
#13	9/8/2004	0.1004	0.1003	0.1011	0.1438	0.1005
#14	9/9/2004	0.1008	0.1002	0.1013	0.1347	0.1006
#15	9/10/2004	0.1006	0.1012	0.1013	0.1801	0.1013
#16	9/13/2004	0.1018	0.1016	0.1026	0.1718	0.1018
#17	9/14/2004	0.1020	0.1025	0.1027	0.2010	0.1028
#18	9/15/2004	0.1028	0.1030	0.1035	0.1999	0.1029
#19	9/16/2004	0.1032	0.1034	0.1039	0.1857	0.1034
#20	9/17/2004	0.1037	0.1038	0.1044	0.1877	0.1042
#21	9/20/2004	0.1043	0.1047	0.1052	0.1991	0.1046
#22	9/21/2004	0.1050	0.1045	0.1054	0.1657	0.1043
#23	9/22/2004	0.1044	0.1043	0.1052	0.1692	0.1044
#24	9/23/2004	0.1048	0.1050	0.1052	0.1785	0.1050
#25	9/24/2004	0.1053	0.1053	0.1059	0.1843	0.1048
#26	9/27/2004	0.1049	0.1046	0.1054	0.1641	0.1044
#27	9/28/2004	0.1054	0.1061	0.1060	0.2608	0.1064
#28	9/29/2004	0.1067	0.1080	0.1075	0.3940	0.1075
#29	9/30/2004	0.1075	0.1073	0.1082	0.2297	0.1071
#30	10/1/2004	0.1077	0.1078	0.1082	0.2431	0.1078
#31	10/4/2004	0.1088	0.1084	0.1095	0.2225	0.1084
#32	10/5/2004	0.1086	0.1088	0.1090	0.2416	0.1092
#33	10/6/2004	0.1093	0.1088	0.1099	0.2260	0.1089

Figure 5: imported pre-processed Dataset

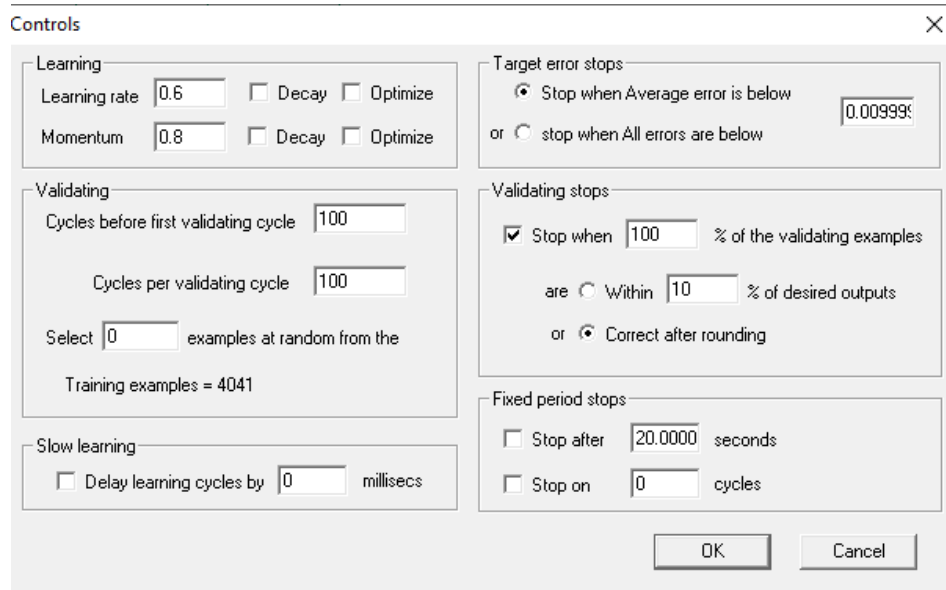

Figure 6: Parameter values of the ANN Model

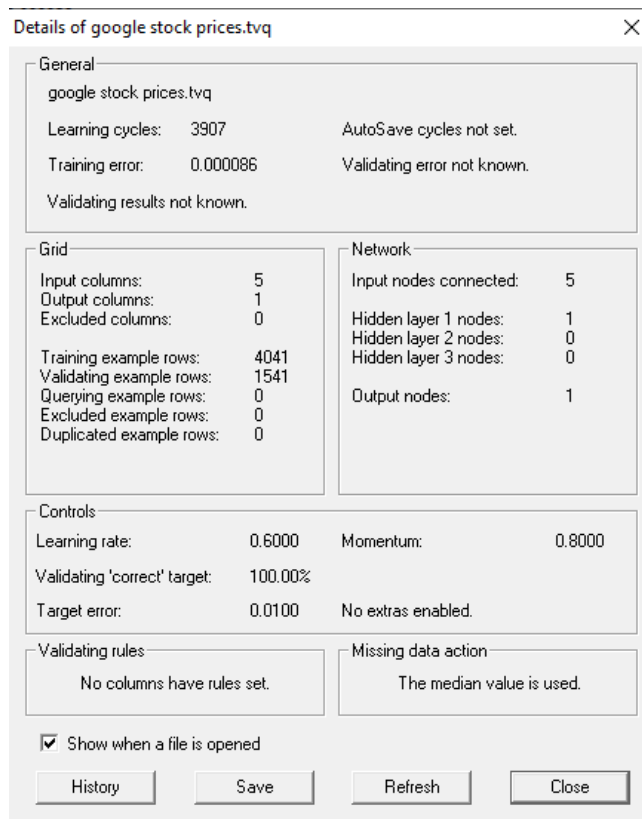

Figure 7: Details of our ANN Model

#### 4. Conclusion

A predictive Artificial Neural Network Model for predicting google stock prices was developed. The Model trained and validated using a dataset from Kaggle. We did some preprocessing on the dataset to make it suitable as input to our ANN model. Validation showed that the model is 99.48% accurate.

## References

1. Zaid, A. A., et al. (2020). "The Impact of Total Quality Management and Perceived Service Quality on Patient Satisfaction and Behavior Intention in Palestinian Healthcare Organizations." *Technology Reports of Kansai University* 62(03): 221-232.
2. Sultan, Y. S. A., et al. (2018). "The Style of Leadership and Its Role in Determining the Pattern of Administrative Communication in Universities-Islamic University of Gaza as a Model." *International Journal of Academic Management Science Research (IJAMSR)* 2(6): 26-42.
3. Salman, F. M. and S. S. Abu-Naser (2019). "Expert System for Castor Diseases and Diagnosis." *International Journal of Engineering and Information Systems (IJEAIS)* 3(3): 1-10.
4. Saleh, A., et al. (2020). Brain tumor classification using deep learning. 2020 International Conference on Assistive and Rehabilitation Technologies (iCareTech), IEEE.
5. Salama, A. A., et al. (2018). "The Role of Administrative Procedures and Regulations in Enhancing the Performance of The Educational Institutions-The Islamic University in Gaza is a Model." *International Journal of Academic Multidisciplinary Research (IJAMR)* 2(2): 14-27.
6. Nassr, M. S. and S. S. Abu-Naser (2018). "Knowledge Based System for Diagnosing Pineapple Diseases." *International Journal of Academic Pedagogical Research (IJAPR)* 2(7): 12-19.
7. Nasser, I. M., et al. (2019). "Artificial Neural Network for Diagnose Autism Spectrum Disorder." *International Journal of Academic Information Systems Research (IIAISR)* 3(2): 27-32.
8. Nasser, I. M. and S. S. Abu-Naser (2019). "Predicting Tumor Category Using Artificial Neural Networks." *International Journal of Academic Health and Medical Research (IJAHMR)* 3(2): 1-7.
9. Musleh, M. M., et al. (2019). "Predicting Liver Patients using Artificial Neural Network." *International Journal of Academic Information Systems Research (IIAISR)* 3(10): 1-11.
10. Musleh, M. M. and S. S. Abu-Naser (2018). "Rule Based System for Diagnosing and Treating Potatoes Problems." *International Journal of Academic Engineering Research (IJAER)* 2(8): 1-9.
11. Mettleq, A. S. A., et al. (2020). "Mango Classification Using Deep Learning." *International Journal of Academic Engineering Research (IJAER)* 3(12): 22-29.
12. Mettleq, A. S. A. and S. S. Abu-Naser (2019). "A Rule Based System for the Diagnosis of Coffee Diseases." *International Journal of Academic Information Systems Research (IIAISR)* 3(3): 1-8.
13. Masri, N., et al. (2019). "Survey of Rule-Based Systems." *International Journal of Academic Information Systems Research (IIAISR)* 3(7): 1-23.
14. Madi, S. A., et al. (2018). "The Organizational Structure and its Impact on the Pattern of Leadership in Palestinian Universities." *International Journal of Academic Management Science Research (IJAMSR)* 2(6): 1-26.
15. Madi, S. A., et al. (2018). "The dominant pattern of leadership and Its Relation to the Extent of Participation of Administrative Staff in Decision-Making in Palestinian Universities." *International Journal of Academic Management Science Research (IJAMSR)* 2(7): 20-43.
16. Kashkash, K., et al. (2005). "Expert system methodologies and applications-a decade review from 1995 to 2004." *Journal of Artificial Intelligence* 1(2): 9-26.
17. Hilles, M. M. and S. S. Abu-Naser (2017). "Knowledge-based Intelligent Tutoring System for Teaching Mongo Database." *EUROPEAN ACADEMIC RESEARCH* 6(10): 8783-8794.
18. Elzamyly, A., et al. (2015). "Classification of Software Risks with Discriminant Analysis Techniques in Software planning Development Process." *International Journal of Advanced Science and Technology* 81: 35-48.
19. Elsharif, A. A. and S. S. Abu-Naser (2019). "An Expert System for Diagnosing Sugarcane Diseases." *International Journal of Academic Engineering Research (IJAER)* 3(3): 19-27.
20. Elqassas, R. and S. S. Abu-Naser (2018). "Expert System for the Diagnosis of Mango Diseases." *International Journal of Academic Engineering Research (IJAER)* 2(8): 10-18.
21. El-Mashharawi, H. Q., et al. (2020). "Grape Type Classification Using Deep Learning." *International Journal of Academic Engineering Research (IJAER)* 3(12): 41-45.
22. El Talla, S. A., et al. (2018). "The Nature of the Organizational Structure in the Palestinian Governmental Universities-Al-Aqsa University as a Model." *International Journal of Academic Multidisciplinary Research (IJAMR)* 2(5): 15-31.
23. El Talla, S. A., et al. (2018). "Organizational Structure and its Relation to the Prevailing Pattern of Communication in Palestinian Universities." *International Journal of Engineering and Information Systems (IJEAIS)* 2(5): 22-43.
24. Dheir, I. and S. S. Abu-Naser (2019). "Knowledge Based System for Diagnosing Guava Problems." *International Journal of Academic Information Systems Research (IIAISR)* 3(3): 9-15.
25. Dahouk, A. W. and S. S. Abu-Naser (2018). "A Proposed Knowledge Based System for Desktop PC Troubleshooting." *International Journal of Academic Pedagogical Research (IJAPR)* 2(6): 1-8.
26. Barhoum, A. M. and S. S. Abu-Naser (2018). "Black Pepper Expert System." *International Journal of Academic Information Systems Research (IIAISR)* 2(8): 9-16.
27. Ashqar, B. A. M. and S. S. Abu-Naser (2019). "Identifying Images of Invasive Hydrangea Using Pre-Trained Deep Convolutional Neural Networks." *International Journal of Academic Engineering Research (IJAER)* 3(3): 28-36.
28. Anderson, J., et al. (2005). "Adaptation of Problem Presentation and Feedback in an Intelligent Mathematics Tutor." *Information Technology Journal* 5(5): 167-207.
29. AlZamily, J. Y. and S. S. Abu-Naser (2018). "A Cognitive System for Diagnosing Musa Acuminata Disorders." *International Journal of Academic Information Systems Research (IIAISR)* 2(8): 1-8.
30. Al-Shawwa, M. and S. S. Abu-Naser (2019). "Knowledge Based System for Apple Problems Using CLIPS." *International Journal of Academic Engineering Research (IJAER)* 3(3): 1-11.
31. Alshawwa, I. A., et al. (2020). "Analyzing Types of Cherry Using Deep Learning." *International Journal of Academic Engineering Research (IJAER)* 4(1): 1-5.
32. Al-Nakhal, M. A. and S. S. Abu Naser (2017). "Adaptive Intelligent Tutoring System for learning Computer Theory." *EUROPEAN ACADEMIC RESEARCH* 6(10): 8770-8782.
33. Almurshidi, S. H. and S. S. Abu Naser (2017). "Design and Development of Diabetes Intelligent Tutoring System." *EUROPEAN ACADEMIC RESEARCH* 6(9): 8117-8128.
34. Almasri, A., et al. (2019). "Intelligent Tutoring Systems Survey for the Period 2000-2018." *International Journal of Academic Engineering Research (IJAER)* 3(5): 21-37.
35. Almasri, A., et al. (2018). "The Organizational Structure and its Role in Applying the Information Technology Used In the Palestinian Universities-Comparative Study between Al-Azhar and the Islamic Universities." *International Journal of Academic and Applied Research (IIAAR)* 2(6): 1-22.
36. Al-Habil, W. I., et al. (2017). "The Impact of the Quality of Banking Services on Improving the Marketing Performance of Banks in Gaza Governorates from the Point of View of Their Employees." *International Journal of Engineering and Information Systems (IJEAIS)* 1(7): 197-217.
37. Alhabbash, M. I., et al. (2016). "An Intelligent Tutoring System for Teaching Grammar English Tenses." *EUROPEAN ACADEMIC RESEARCH* 6(9): 7743-7757.
38. AlFerjany, A. A. M., et al. (2018). "The Relationship between Correcting Deviations in Measuring Performance and Achieving the Objectives of Control-The Islamic University as a Model." *International Journal of Engineering and Information Systems (IJEAIS)* 2(1): 74-89.
39. Al-Bastami, B. G. and S. S. Abu Naser (2017). "Design and Development of an Intelligent Tutoring System for C# Language." *EUROPEAN ACADEMIC RESEARCH* 6(10): 8795.
40. Alajrami, M. A. and S. S. Abu-Naser (2018). "Onion Rule Based System for Disorders Diagnosis and Treatment." *International Journal of Academic Pedagogical Research (IJAPR)* 2(8): 1-9.
41. Al Shobaki, M., et al. (2018). "Performance Reality of Administrative Staff in Palestinian Universities." *International Journal of Academic Information Systems Research (IIAISR)* 2(4): 1-17.
42. Al Shobaki, M. J., et al. (2018). "The Level of Organizational Climate Prevailing In Palestinian Universities from the Perspective of Administrative Staff." *International Journal of Academic Management Science Research (IJAMSR)* 2(5): 33-58.
43. Al Shobaki, M. J., et al. (2017). "Learning Organizations and Their Role in Achieving Organizational Excellence in the Palestinian Universities." *International Journal of Digital Publication Technology* 1(2): 40-85.
44. Al Shobaki, M. J., et al. (2017). "Impact of Electronic Human Resources Management on the Development of Electronic Educational Services in the Universities." *International Journal of Engineering and Information Systems* 1(1): 1-19.
45. Al Shobaki, M. J., et al. (2016). "The impact of top management support for strategic planning on crisis management: Case study on UNRWA-Gaza Strip." *International Journal of Academic Research and Development* 1(10): 20-25.
46. Al Shobaki, M. J. and S. S. Abu Naser (2016). "The reality of modern methods applied in process of performance assessments of employees in the municipalities in Gaza Strip." *International Journal of Advanced Scientific Research* 1(7): 14-23.
47. Al Shobaki, M. J. and S. S. Abu Naser (2016). "Performance development and its relationship to demographic variables among users of computerized management information systems in Gaza electricity Distribution Company." *International Journal of Humanities and Social Science Research* 2(10): 21-30.
48. Al Shobaki, M. J. and S. S. Abu Naser (2016). "Decision support systems and its role in developing the universities strategic management: Islamic university in Gaza as a case study." *International Journal of Advanced Research and Development* 1(10): 33-47.
49. Ahmed, A. A., et al. (2018). "The Impact of Information Technology Used on the Nature of Administrators Work at Al-Azhar University in Gaza." *International Journal of Academic Information Systems Research (IIAISR)* 2(6): 1-20.
50. Abu-Saqr, M. M., et al. (2020). "Type of Grapefruit Classification Using Deep Learning." *International Journal of Academic Information Systems Research (IIAISR)* 4(1): 1-5.
51. Abu-Saqr, M. M. and S. S. Abu-Naser (2019). "Developing an Expert System for Papaya Plant Disease Diagnosis." *International Journal of Academic Engineering Research (IJAER)* 3(4): 14-21.
52. Abu-Nasser, B. S. and S. S. Abu Naser (2018). "Rule-Based System for Watermelon Diseases and Treatment." *International Journal of Academic Information Systems Research (IIAISR)* 2(7): 1-7.
53. Abu-Naser, S. S., et al. (2011). "An intelligent tutoring system for learning java objects." *International Journal of Artificial Intelligence & Applications (IJALA)* 2(2): 86-77.
54. Abu-Naser, S. S. and M. J. Al Shobaki (2016). "Computerized Management Information Systems Resources and their Relationship to the Development of Performance in the Electricity Distribution Company in Gaza." *EUROPEAN ACADEMIC RESEARCH* 6(8): 6969-7002.
55. Abu-Naser, S. S. and M. A. Al-Nakhal (2016). "A Ruled Based System for Ear Problem Diagnosis and Treatment." *World Wide Journal of Multidisciplinary Research and Development* 2(4): 25-31.
56. Abu-Naser, S. S. (2016). "ITSB: An Intelligent Tutoring System Authoring Tool." *Journal of Scientific and Engineering Research* 3(5): 63-71.
57. Abu-Naser, S. S. (2009). "Evaluating the effectiveness of the CPP-Tutor, an Intelligent Tutoring System for students learning to program in C++." *Journal of Applied Sciences Research* 5(1): 109-114.
58. Abu-Naser, S. S. (2008). "JEE-Tutor: An Intelligent Tutoring System for Java Expression Evaluation." *Information Technology Journal* 7(3): 528-532.
59. AbuEloun, N. N. and S. S. Abu-Naser (2017). "Mathematics intelligent tutoring system." *International Journal of Advanced Scientific Research* 2(1): 11-16.
60. Abu Naser, S. S., et al. (2017). "Trends of Palestinian Higher Educational Institutions in Gaza Strip as Learning Organizations." *International Journal of Digital Publication Technology* 1(1): 1-42.
61. Abu Naser, S. S., et al. (2016). "Measuring knowledge management maturity at HEI to enhance performance-an empirical study at Al-Azhar University in Palestine." *International Journal of Commerce and Management Research* 2(5): 55-62.
62. Abu Naser, S. S. and M. J. Al Shobaki (2016). The Impact of Management Requirements and Operations of Computerized Management Information Systems to Improve Performance (Practical Study on the employees of the company of Gaza Electricity Distribution). First Scientific Conference for Community Development.
63. Abu Naser, S. S. (2008). "Developing an intelligent tutoring system for students learning to program in C++." *Information Technology Journal* 7(7): 1055-1060.
64. Abu Naser, S. S. (2006). "Intelligent tutoring system for teaching database to sophomore students in Gaza and its effect on their performance." *Information Technology Journal* 5(5): 916-922.
65. Abu Naser, S. S. (1999). "Big O Notation for Measuring Expert Systems complexity." *Islamic University Journal Gaza* 7(1): 57-70.
66. Abu Naser, S. S. (1993). A methodology for expert systems testing and debugging. North Dakota State University, USA.
67. Abu Nada, A. M., et al. (2020). "Arabic Text Summarization Using AraBERT Model Using Extractive Text Summarization Approach." *International Journal of Academic Information Systems Research (IIAISR)* 4(8): 6-9.
68. Abu Nada, A. M., et al. (2020). "Age and Gender Prediction and Validation through Single User Images Using CNN." *International Journal of Academic Engineering Research (IJAER)* 4(8): 21-24.
69. Abu Amuna, Y. M., et al. (2017). "Understanding Critical Variables for Customer Relationship Management in Higher Education Institution from Employees Perspective." *International Journal of Information Technology and Electrical Engineering* 6(1): 10-16.
70. Abu Amuna, Y. M., et al. (2017). "Strategic Environmental Scanning: an Approach for Crises Management." *International Journal of Information Technology and Electrical Engineering* 6(3): 28-34